

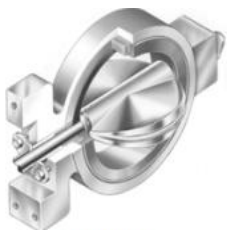

# Rotary / Control Valves V..., 8.... + 9....+ A...-type series



## High-Performance Butterfly Valves



9500 VALVF



8580 VALVE



A11 VALVE



V260 VALVE



Fisher Control-Disk Valve  
Vee-Ball™ VALVE



Control-Disk™ VALVE

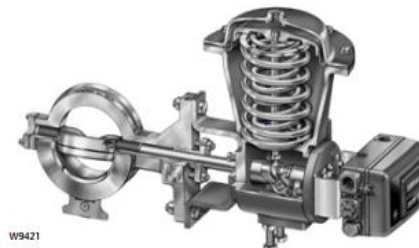

Control-Disk VALVE

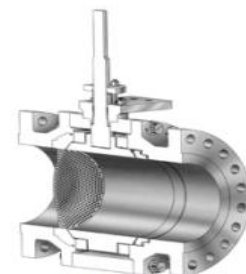

V260 VALVE

Control-Disk Valve	Expanded control range, lower process variability	Fisher Control-Disk Valve
Vee-Ball Valves	High-capacity, low-friction, non-clogging	Fisher V150, V200, V300, and V150S
High-Performance Butterfly Valves	Outstanding performance under extreme pressure and temperature conditions, available for a variety of throttling or on/off applications	Fisher 8532, 8580, 8590, 9500, A11, A31A, A31C, and A31D
Pipeline Valves	Full- or reduced-bore ball valves for throttling and severe service applications in gas transmission lines, gas distribution, or liquid pipelines	Fisher V250 and V260
Eccentric Plug Valves	Designed for throttling control for a broad range of industrial applications	Fisher V500 and CV500

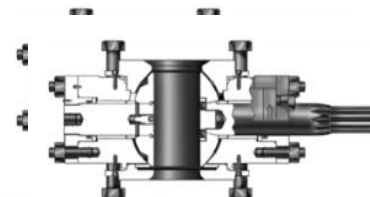

V250 VALVE

W711

W7169

## Pipeline Valves

Contact us for a comprehensive **Valve Selection Guide**

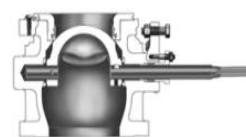

V150 and V300 VALVES

W74351

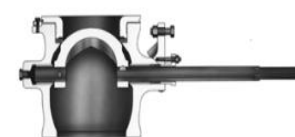

V200 VALVE

W5787

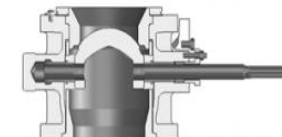

V150S VALVE

W8509